

Model Number: ZRIRD-RGB-24K

Product Name: RGB Bluetooth LED Controller



## I: Product Parameter:

Category	LED Controller
Domination Principle	BT
APP	Magic Byte
Language	Chinese、English、German
Operation Platform	Android 5.0or IOS 9.0 or higher
LED Drive Type	Constant voltage:MOSFET
Channels	GRB
Input Voltage	DC (12-24)V
Max Output Power	144W
Work For	LED Strip or other constant voltage lights
Connect Method	Common Anode
Working Temperature	-20~+55°C
Control Distance	BT:20m,Remote controller: 10m
Certification	CE, RoHS,FCC
Warranty	1 Year
Net Weight	43g
Dimension(L*B*H)	50MM*35MM*22MM
Carton Size(L*B*H)	47.2CM*34.2CM*23.2CM
QTY Per Carton	200Sets/CTN
Gross Weight	10.85kg

## II: Instruction of Remote Controller

### 24-key infrared control instruction: (For controllers with infrared function)

1. The default setting of the controller is 3 channels in the sequence of RGB (sequence of GRBW for GRBW version, GRBWC for GRBWC version). If you want to change the output channel, the steps are as follows: unplug the controller power and then plug in again. When the light up, long press the key **B** for 2 to 3s, the flickering white light means you've successfully changed the output channel to BRG; Similarly, long press key **G** will change the channel to GRB sequence; long press key **R** to RGB sequence.

2. In RGBW version, press W key for RGB and white light; long press W key for 2 seconds will switch to W channel.

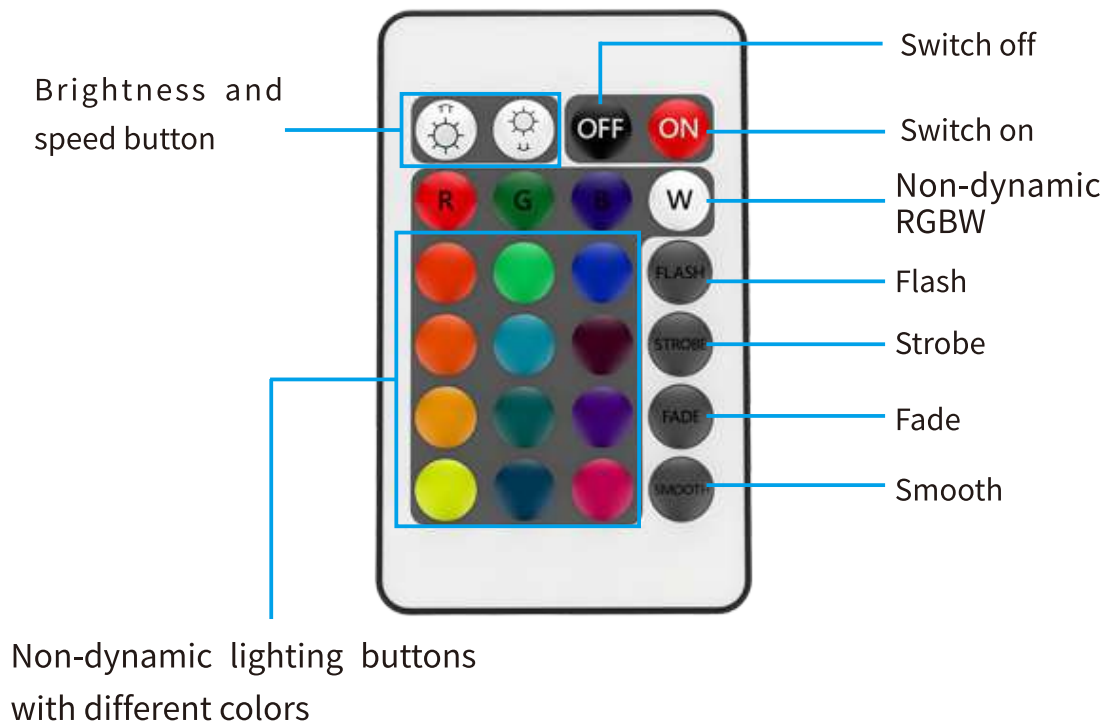

### III: APP Interface Instruction

#### a) Support 16 million color control and brightness adjustment

You can adjust both the color RGB(Red/Green/Blue) as well as the brightness of the color. It's likewise possible in this function to adjust and store 5 own created colors and brightness levels. You can save this, if you press long on the “DIY” button. The adjusted color/brightness will be stored and displayed in the “DIY” button. You can recall the color/brightness if you press shortly on one of the five DIY buttons. On the display top left, the individual channels R/G/B can be called separately and adjusted from 0-255 to obtain the desired color.

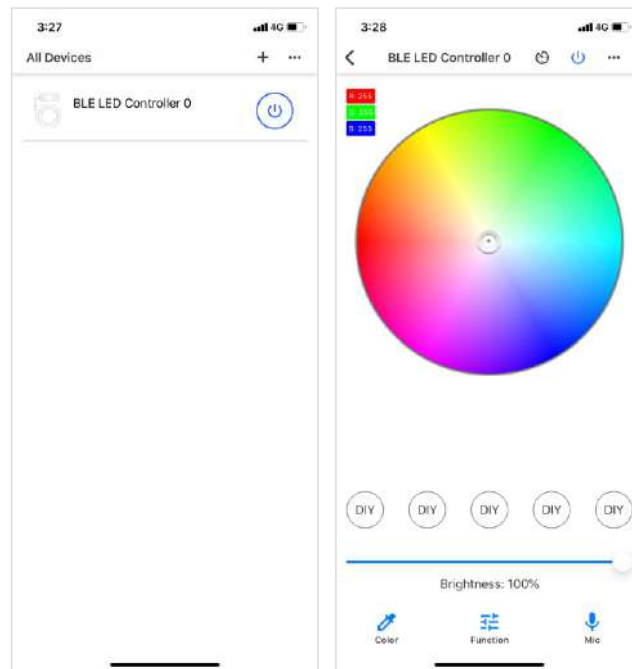

#### b) Function

In this capacity, 20 programmed are preset. In addition, you can adjust the speed of the gradients with a slider. With the keys M+/M- or scroll up and down you can switch between the preset modes.



### c) Microphone function

Click/ go to “Mic” interface of the APP.

In this function the connected LED light lights up depending on the volume/noise from the outside like a microphone. This also works when playing music or there is a noise from outside, the light will begin “dancing” base on different rhythm. The microphone sensitivity can be adjusted by the slider.

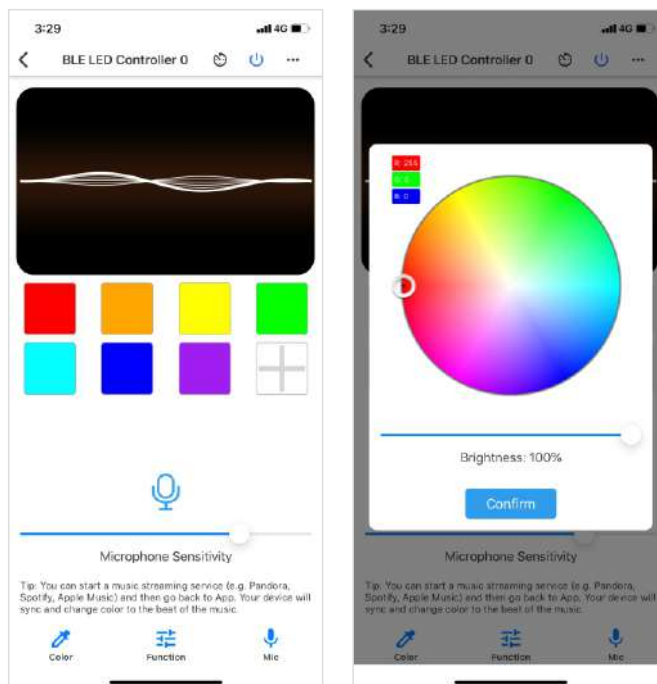

### d) Support delay light off setting

Click the delay icon at the top to set the delay off time to make life more convenient.

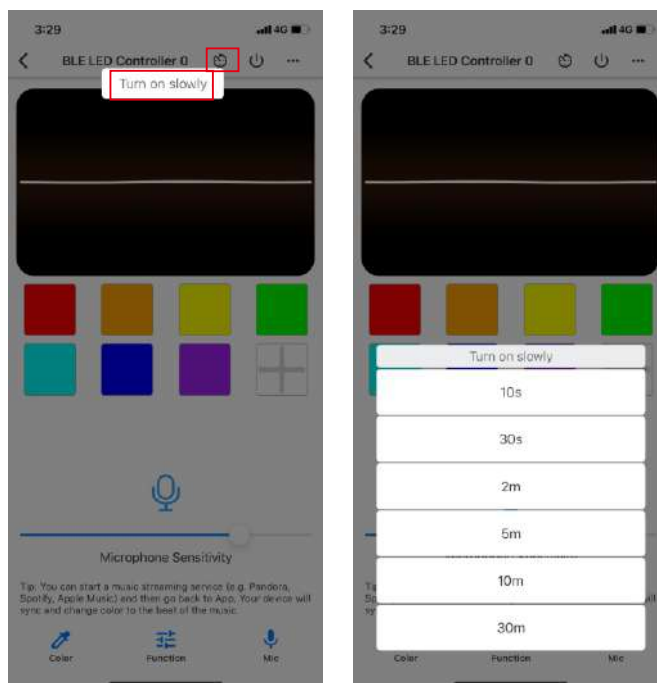

### e) Group Function: control all the LED lights at the same time

- 1) Create group(s) and add the LED lights into group(s).
- 2) You can control the LED lights with color change, brightness change, turn on/turn off etc.
- 3) You can rename group(s) to make them easier for use .

## f) Light timer

The controller has a built-in timer function. You can have your lights automatically turn on or off in a specified time by setting up the timer. Press on the top right, next to ON/OFF, switch the clock icon. Then the selection menu will be shown with time, Repeat (Mon-Sun), ON/OFF switch and the optional Model (color setting, Brightness and gradient program.) The timer will not operate when the power supply is interrupted. In this case, start the APP to resynchronize.

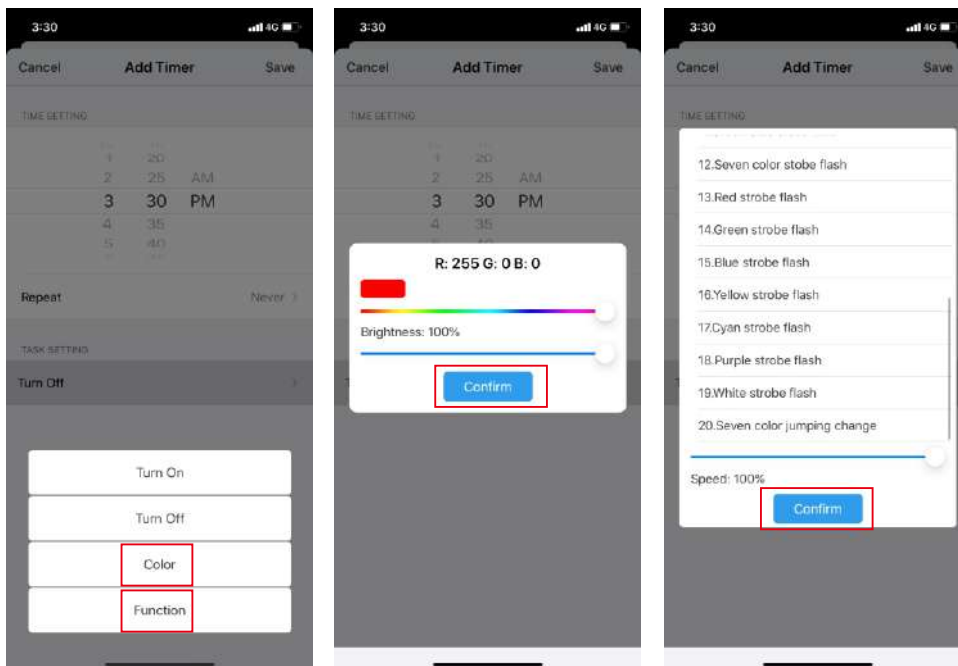
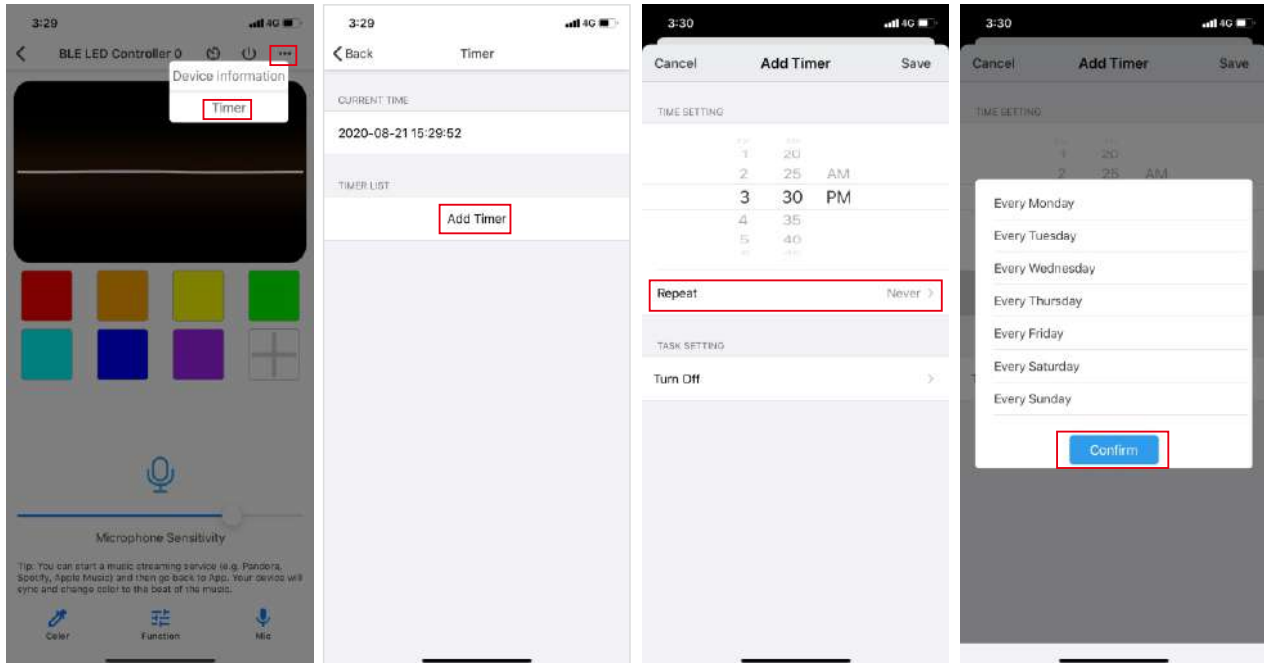

## ATTENTIONS

1. Please use the product in a dry environment.
2. Please use the input voltage at 12-24V DC voltage, must not connect into 220V AC directly.
3. The product is requested common anode connection. The wrong connection will cause a malfunction.