

# BT Mesh Smart Touch Panel Remote Controller

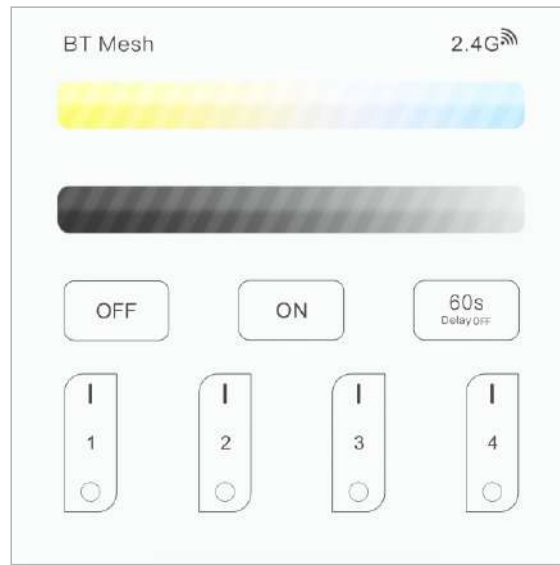

BT Mesh Touch Panel Remote Controller is a newly developed remote controller. This Remote Panel Controller is designed by a delicate and fashionable tempered glass panel. We adopt a high precision capacitive touch screen IC, the touch screen is very stable; 2.4GHz high RF control with long distance controlling, low power consumption and high speed transmitting rate. It can be remote controlled or voice controlled by Amazon Alexa & Google Assistant by adding our Smart Bridge. The product divides into the low voltage (DC, Powered by battery) series and the high voltage series (AC), and the difference lies in the different ways of power supply. There are 4 models in each of the two series: Single color touch panel dimmer; CCT touch panel controller; RGBW touch panel controller and RGBWC touch panel controller. They are widely used in our smart LED lightings, LED controllers and other smart home appliances.

# Product Name : BT Mesh Touch Panel Remote Controller-CCT TRBM-CCT-D

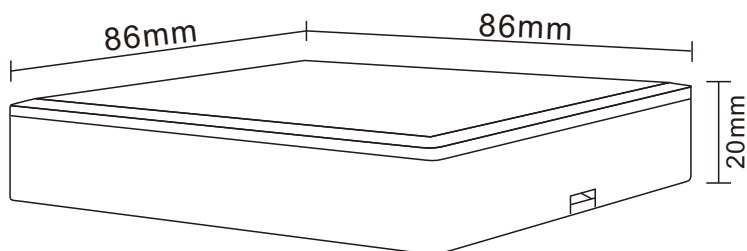

Category	Smart Panel Remote Controller
Domination Principle	BLUETOOTH 4.2
APP	Hao Deng
Language	Chinese、English
Operation Platform	Android 4.4 or IOS 9.0 or higher
Channels	2
Input Voltage	3V(2*AAA Battery)
Standby Power	13uA
Transmitting Power	8dBm
Working Temperature	-20-55°C
Certificates	CE、RoHS、FCC
Control Distance	Visible distance 30M
Net Weight	133g
Dimension(L*B*H)	86MM*86MM*20MM

## 1: Installation/Dismantlement

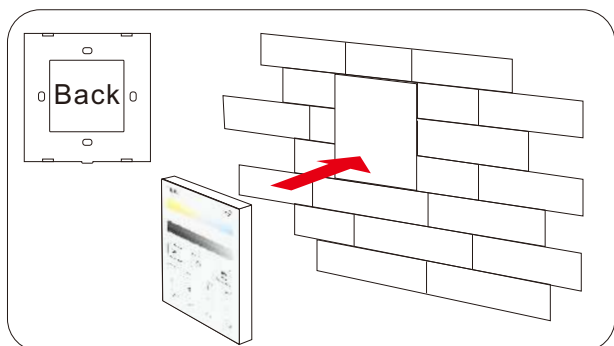

- Fixing Method:
1. Fixed by the double-sided adhesive.
  2. Fixed by screws.

### Attention:

1. Please check the cable, and make sure the circuit is correct before power on.
2. Please handle with care during installation to avoid the broken of the glass panel.

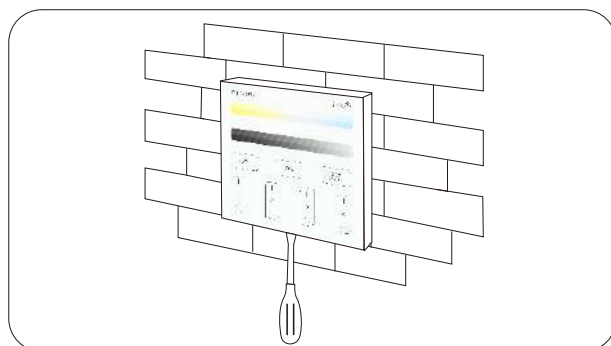

Note: The panel controller can be disassembled by inserting the screwdriver from the disassembly port located below the back of the product.

## 2. How to activate the remote panel controller

Long press the "OFF" and "ON" keys at the same time, the light will continue flashing and the controller will sound 3 times after 5 seconds, release your finger and the activation will succeed. Otherwise, please try again.

(For DC series products only, AC series can be added directly in the APP)

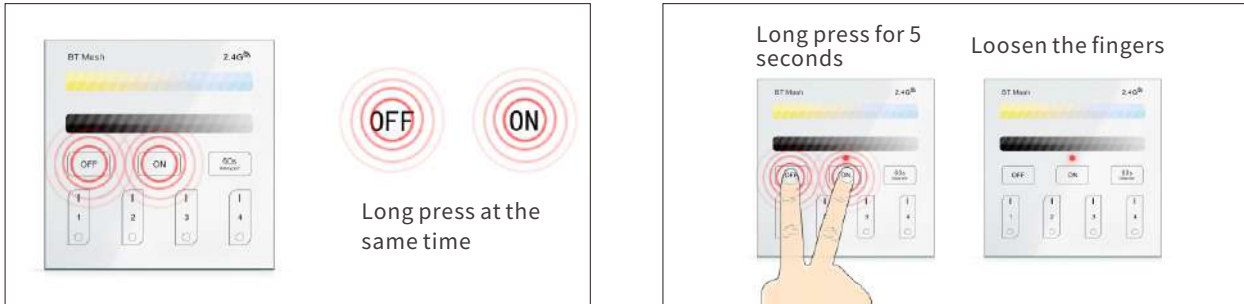

Please do not touch the other keys besides "OFF" & "ON", otherwise the activate will fail.

## 3. How to restore factory settings

Long press "OFF" & "ON" keys for 25 seconds, the light will continue flashing, release your finger until you hear the indicator sound.

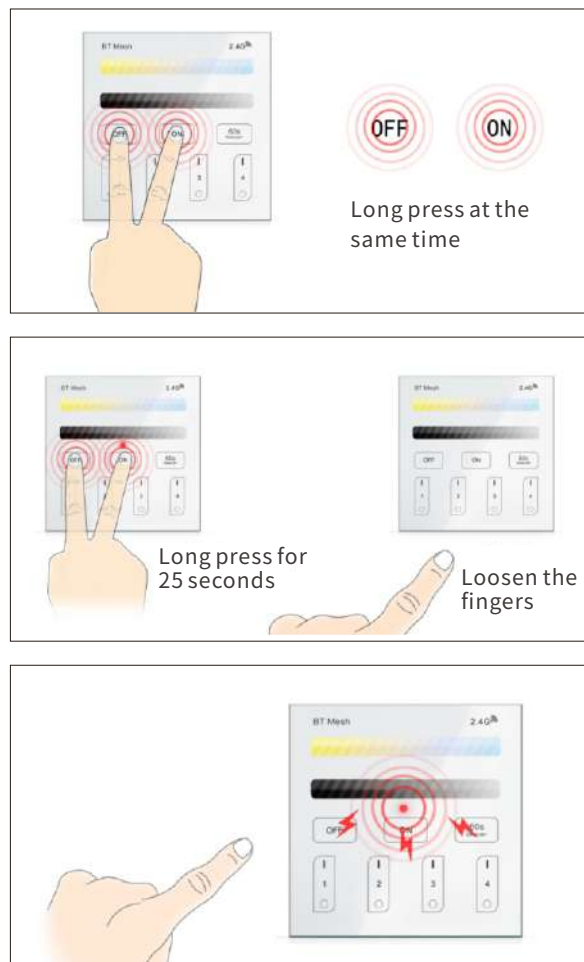

Please do not touch the other keys besides "OFF" & "ON", otherwise the reset will fail.

#### 4: Instructions

1) After installing the device and confirming the device is powered on, press "ON" and you will hear an indicator sound, indicating successful pairing with other bluetooth mesh products. Now you can control the Bluetooth Mesh products by the remote control panel directly. (This operation can only achieve synchronous control of the devices and Group control function is not available).

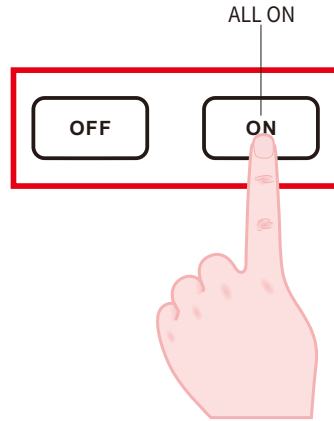

2) Add the new bluetooth mesh remote panel controller to Hao Deng APP.

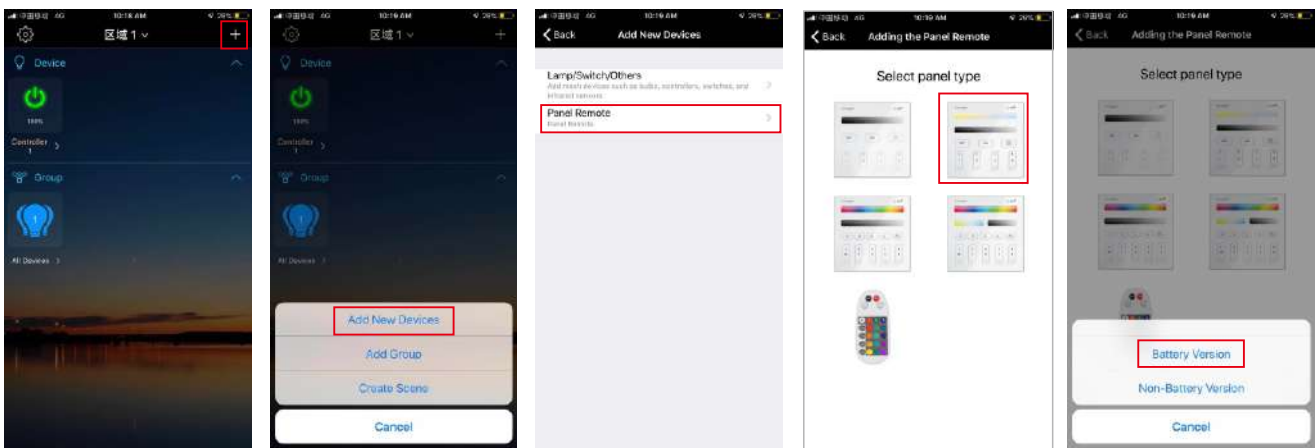

3) Please follow the below instructions to activate the remote control panel: First of all, confirm the indicator light is in fading mode, then click on "Next". (After adding the panel controller successfully, the "I" and "O" keys does not work temporarily. The lamps/switches/other device must be assigned to the 1-4 configuration group before operation).

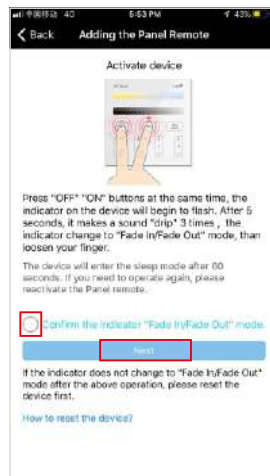

#### 4) How to assign the lamps/switches/other devices to 1-4 groups?

a: First, confirm that the remote control panel is in "activated" status, then click on the remote control panel for group configuration, select a group in 1-4 groups and configure the lights/switches/other devices into the group (up to 64 devices can be added in a group, and all the devices can be added to different groups repeatedly).

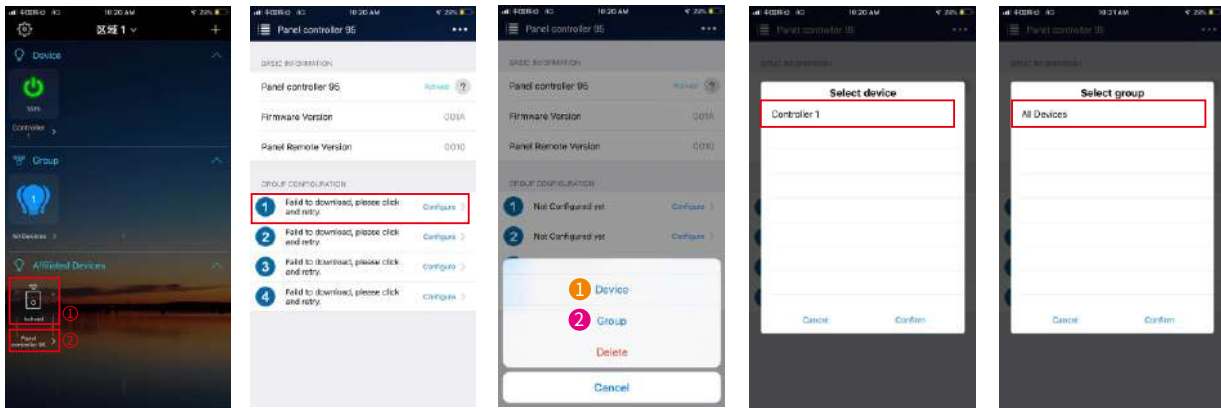

Note: When selecting menu "❶" (Device), only single device can be controlled in the group; Selecting menu "❷" (Group) can control multiple devices in the group at the same time.

b: If the remote control panel is inactive, please refer to "How to activate the remote control panel" and reactivate it.

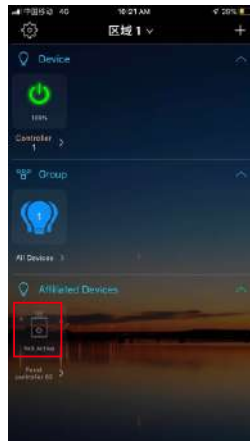

c: After grouping, you can control the devices on the remote control panel directly. (The remote control panel needs to be activated before adding any new devices).

Note: The DC series remote control panel will be automatically displayed as off-line power saving mode in the APP after configuration is completed but there is no operation, but it can still be operated directly through the remote panel controller (This is not exist in the AC series products).

d: This remote control panel is compatible with all of our BT Mesh products.

